

CHARTER TOWNSHIP OF UNION
ZONING MAP - Through Ordinance 2012-07

- AG Agricultural
- B-4 General Business
- B-5 Highway Business
- B-6 Auto-Related Highway Business
- B-7 Retail and Service Highway Business
- CITY
- CMU
- I-1 Light Industrial
- I-2 General Industrial
- OS Office / Service
- R-1 One-family Residential
- R-2A One and Two-Family District
- R-2B One and Two-Family District
- R-3A Apartment and Condominiums
- R-3B Medium Density Apartment & Condos
- R-4 Mobile or Modular Home District
- R-5 Single-wide Mobile Home District
- Saginaw Chippewa Indian Tribe Trust Lands

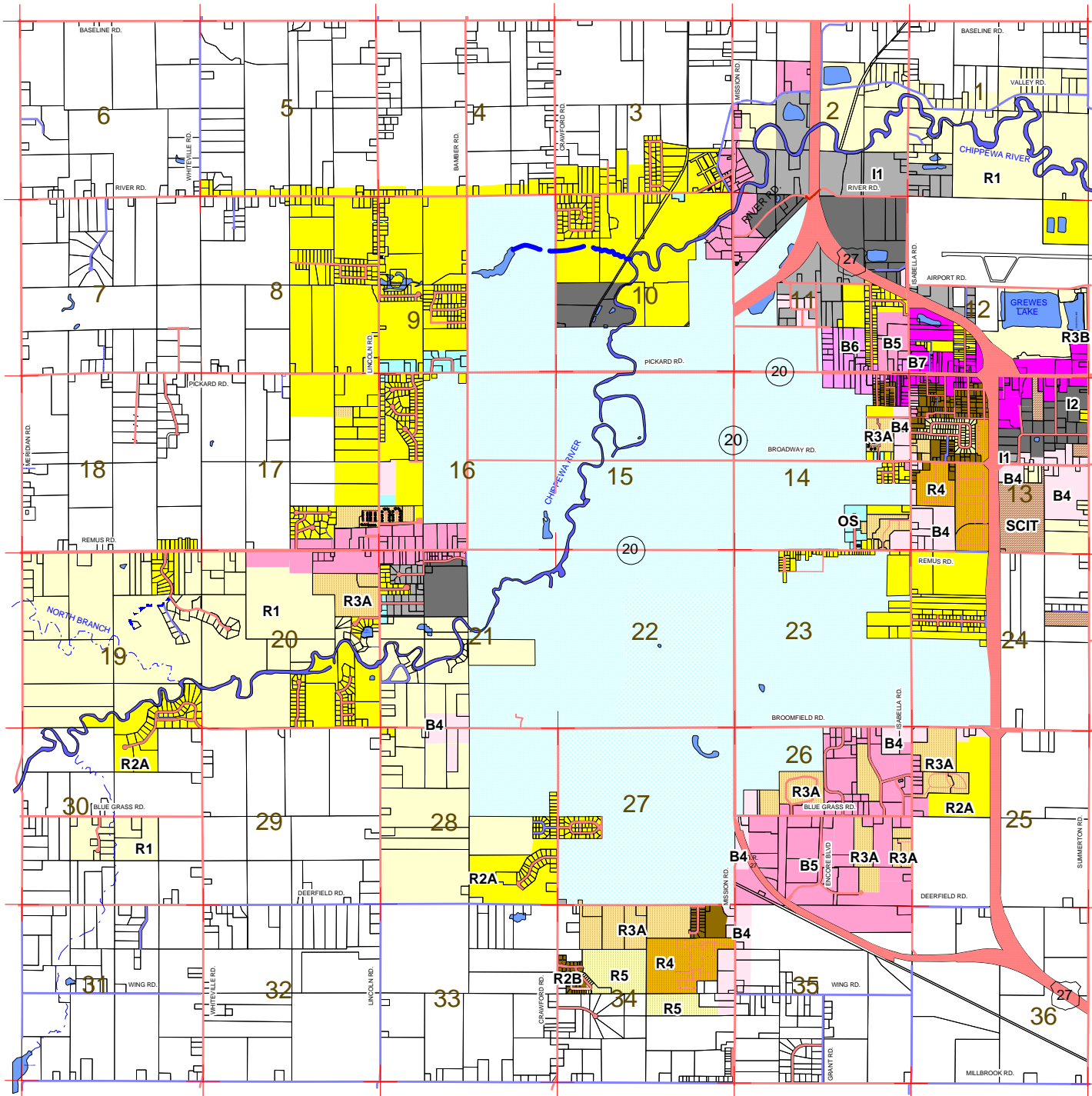

33 SECTION NUMBER

N

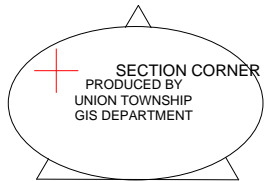

SECTION CORNER
PRODUCED BY
UNION TOWNSHIP
GIS DEPARTMENT

CHARTER TOWNSHIP OF UNION
T14N, R4W
ISABELLA COUNTY, MICHIGAN