

# of Projects	Proposed Project List and Cost For EDDA 2011 Development Plan (As Approved by EDA)	Est. Cost	Status	Comments	Priority
1	Reseeding and upgrading of lawns where needed on Pickard and Isabella	\$10,000.00			
2	Paving of Bud Street	\$100,000.00	Complete		
3	Develop professional park plan for upgrading of Jameson Park landscaping and facilities	\$7,500.00			
4	Implement plan for Jameson Park modernization of landscaping and facilities	\$50,000.00			
5	land acquisition for Jameson Park expansion	\$100,000.00	Reviewed/Declined	Cost Prohibitive	
6	Bicycle path along Airport Road and south on Summerton in accordance with area Non- Motorized Transportation Plan 1 mile non motorized path for Airport Rd. (Isabella to Summerton) \$580,160 .5 mile non motorized path for Summerton Rd. (Airport to Pickard) \$65,430	\$580,160.00 \$65,430.00			
7	Work with MDOT on improvements on Pickard from 127 to Summerton to deal with increased water park traffic	\$250,000.00			
8	Additional sidewalks in accordance with area Non-Motorized Transportation Plan on Broadway, Isabella, Summerton, and Pickard Rds 2.5 miles of sidewalk on Broadway Rd. (Twp. line to Summerton Rd) 1.5 miles of sidewalk on Summerton Rd. (Airport to Remus Rd) .75 mile of sidewalk on Isabella Rd. (Kay St. to Broadway) .25 mile of sidewalk on Pickard (just west of Summerton Rd)	\$187,500.00 \$112,500.00 \$75,000.00 \$18,750.00			
9	Way finding Program working with CMU, MMCC, Tribe, City and County	\$15,000.00			
10	Improvements at corner of Broadway and Summerton to deal with increased motorized and pedestrian traffic at new MMCC campus Only 1 corner of intersection is in EDDA	\$50,000.00			
11	Isabella Road: Broadway to Pickard - Mill and Fill (bad wheel rutting) Current paser rating of 8 with 10 being the best	\$85,000.00			
12	Parkway/Venture way/Enterprise Drive (Enterprise Park) needs drainage improvements and resurfacing Either an overlay or pulverize and pave	\$500,000.00	Complete		
13	Summerton Road (Pickard to Airport) needs an overlay	\$51,840.00			
14	Hyde Road (South of Pickard) needs reconstructed with proper turn around	\$50,000.00	Complete		

UPDATED 6/27/2016

# of Projects	Proposed Project List and Cost for EDDA 2014 Development Plan (As Approved by EDA)	Est. Cost	Status	Comments	Priority
15	Airport Road (Packard to Belmont) existing gravel needs constructed and paved	\$125,000.00			
16	Water main looping from Airport Road to Pickard	\$250,000.00			
17	Manhole rehabilitation at various locations within EDDA 33 manholes @ \$8,000 each	\$264,000.00	Pending	K. Smith to Provide Update	
	Total Project Cost	\$2,947,680.00			
	Maintenance/Contractual/Utilities - 10 yrs	\$775,000.00			
	Total 10 Yr Cost Estimate	\$3,722,680.00			

10 Yr. Estimated Revenue
2011 Est. Rev of \$640,109 x 10 yrs x 1.1 Combined CPI Increase in Tax Roll
10 Yr. Cost Estimate
Balance

Potential Projects Pending Availability of Funding
Bury/Move Overhead Utility Lines: Pickard and Isabella
Summerton to US127
US 127 to Isabella Rd
Isabella Rd to Pickard St.
Total Potential Project Cost

PROPOSAL

I-DEAL SEALCOATING, INC.

1961 Arbor Dr.
Lake, Mi. 48632
989-588-2803
idealasphaltsealcoating.com
Fully Insured

DATE: 6/24/16

Submitted To:
Bill Newkirk

Work To Be Performed At:
Jameson Park
5142 Bud St.
Mt. Pleasant, MI 48858

We hereby propose to furnish and install the materials listed.

SEALCOATING (approx. 27,240 Sq. ft.)

- ❖ Power Clean Area.
- ❖ Neutralize Oil Spots.
- ❖ **Power Brush Apply (2) coat(s) of Arnguard Asphalt Sealer with Silica Sand and Tarmax R-100 for extra strength and durability.**

CRACK SEALANT (approx. 2,119 L.F.)

- ❖ Power Clean Out Cracks.
- ❖ Fill Cracks with Hot Rubberized Crack Sealant and Silica Sand where needed.

STRIPING

- ❖ As previously done.

ASPHALT REPAIR

- ❖ 12 x 24 Sawcut
Rip out & Replace with 3" Asphalt

All Material is guaranteed to be as specified, and the above work is to be performed in a substantial workmanlike manner for the sum of: **\$4,543.00**

With payment to be made upon completion of job, unless otherwise specified.

ACCEPTANCE OF PROPOSAL

DATE _____

Respectfully Submitted: CEM H

You are authorized to do the work as specified. Payment will be made as outlined above. _____

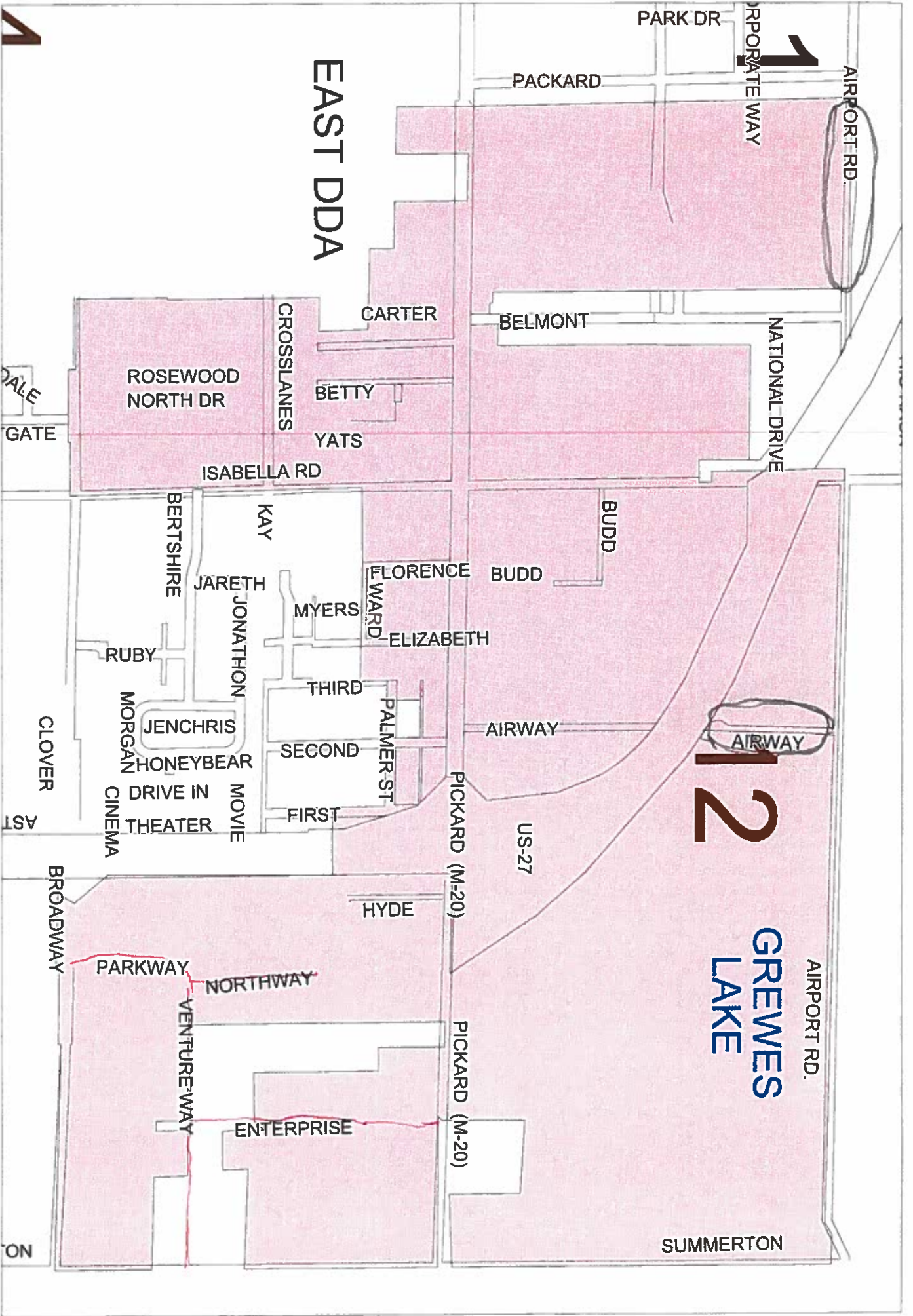

EAST DDA

12
GREWES LAKE

AIRPORT RD.

SUMMERTON

AIRPORT RD.

1
CORPORATE WAY

NATIONAL DRIVE

PACKARD

BELMONT

CARTER

CROSSLANES

ROSEWOOD NORTH DR

BETTY

YATS

ISABELLA RD

BERTSHIRE

KAY

JARETH

JONATHON

MYERS

FLORENCE

BUDD

BUDD

WARD

ELIZABETH

RUBY

THIRD

PALMER ST

AIRWAY

AIRWAY

US-27

PICKARD (M-20)

HYDE

PICKARD (M-20)

ENTERPRISE

PARKWAY

NORTHWAY

VENTURE WAY

BROADWAY

CLOVER

DRIVE IN THEATER

MORGAN

JENCHRIS

HONEYBEAR

DALE

GATE

AST

ON

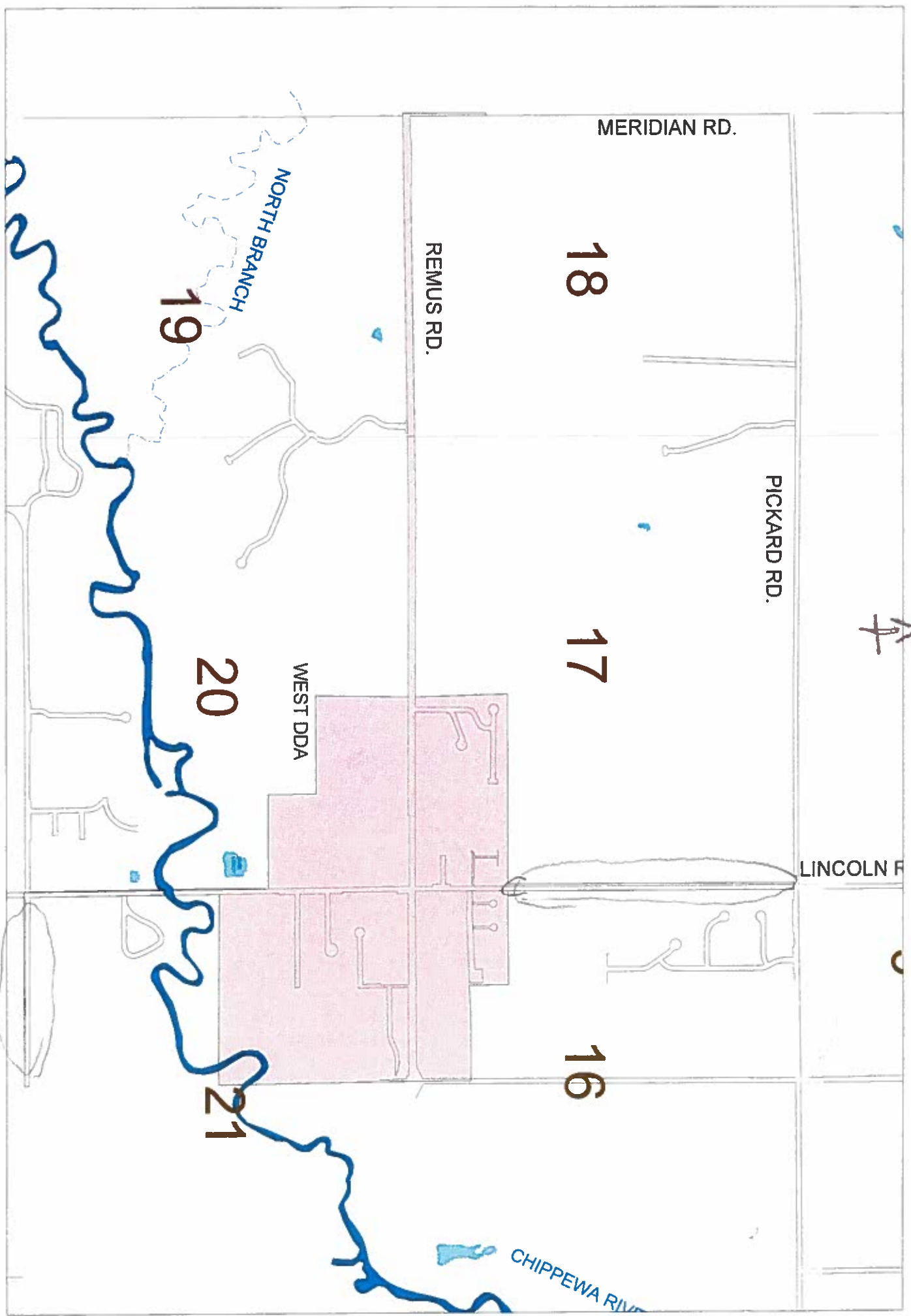

MERIDIAN RD.

18

REMUS RD.

PICKARD RD.

17

19

NORTH BRANCH

20

WEST DDA

LINCOLN F

16

21

CHIPPEWA RIVER

